

TRANSOMS OVER WINDOW & DOORS

OPEN UP THE WALLS FOR MORE LIGHT

Copy this classic detail into your plans if you would like to modify the window and door headers to allow extra high transom windows.

Check with your window supplier to see what options they have for transom windows or simulated transoms with grid patterns in taller windows.

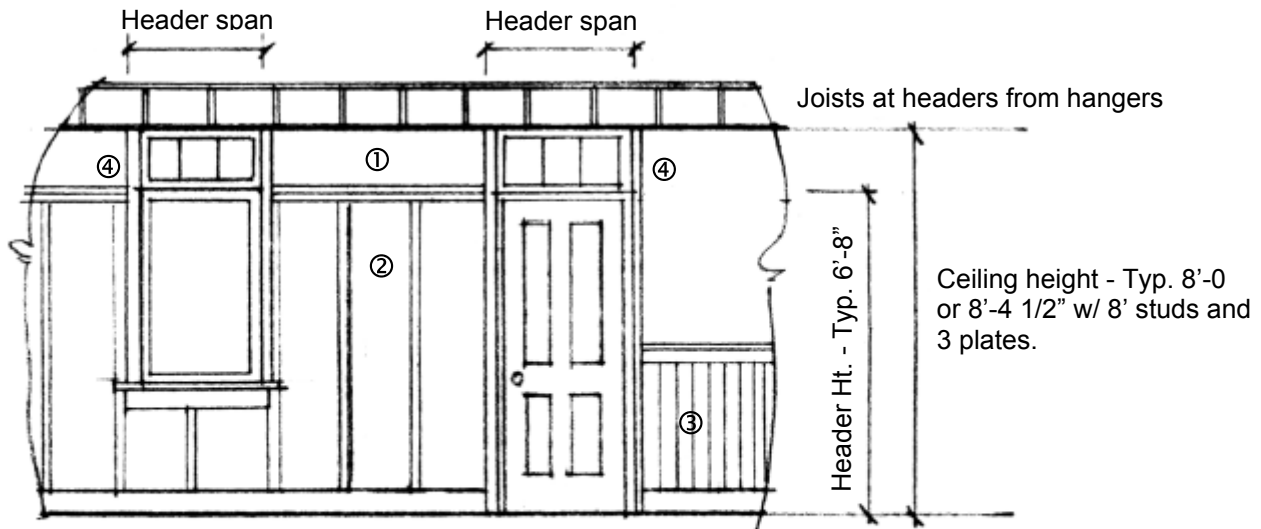

Paint Grade Trim Details w/ Transoms
1/4" = 1'-0"

- ① Picture rail at Header Ht.
- ② 1/2"x2 battens o/ drywall (glue & paint).
- ③ Chair rail and wainscoting
- ④ Individual transom windows or taller windows with grid pattern to align grids

TRANSOMS FOR SHORT WALLS

Confirm header size w/ chart or per plans.
© John Raabe, CountryPlans.com, Planhelp.com, 2006

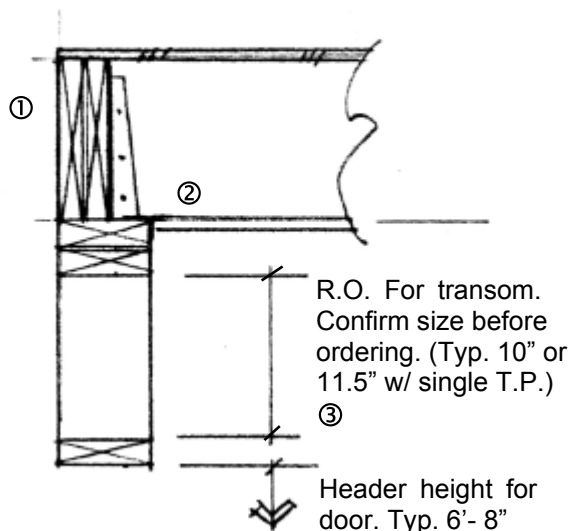

- ① Spike 2nd (or 3rd) joist to standard rim joist to serve as header. Extend header joist 3" each side beyond opening. Dbl studs at openings 6' or wider. Nail header joist to rim w/ 16d nails 6" o/c top and bottom. Hang joists from hangers. Use similar header where joists are parallel to wall.
- ② Drywall clip to top plate.
- ③ Raise wall heights (if needed) for transom height with taller studs (96" rather than precuts.) or extra plates.

Framing Detail at Transoms
1" = 1'-0"