

TIMBER STYLE OPEN BEAM CEILING FOR 20' WIDE COTTAGES

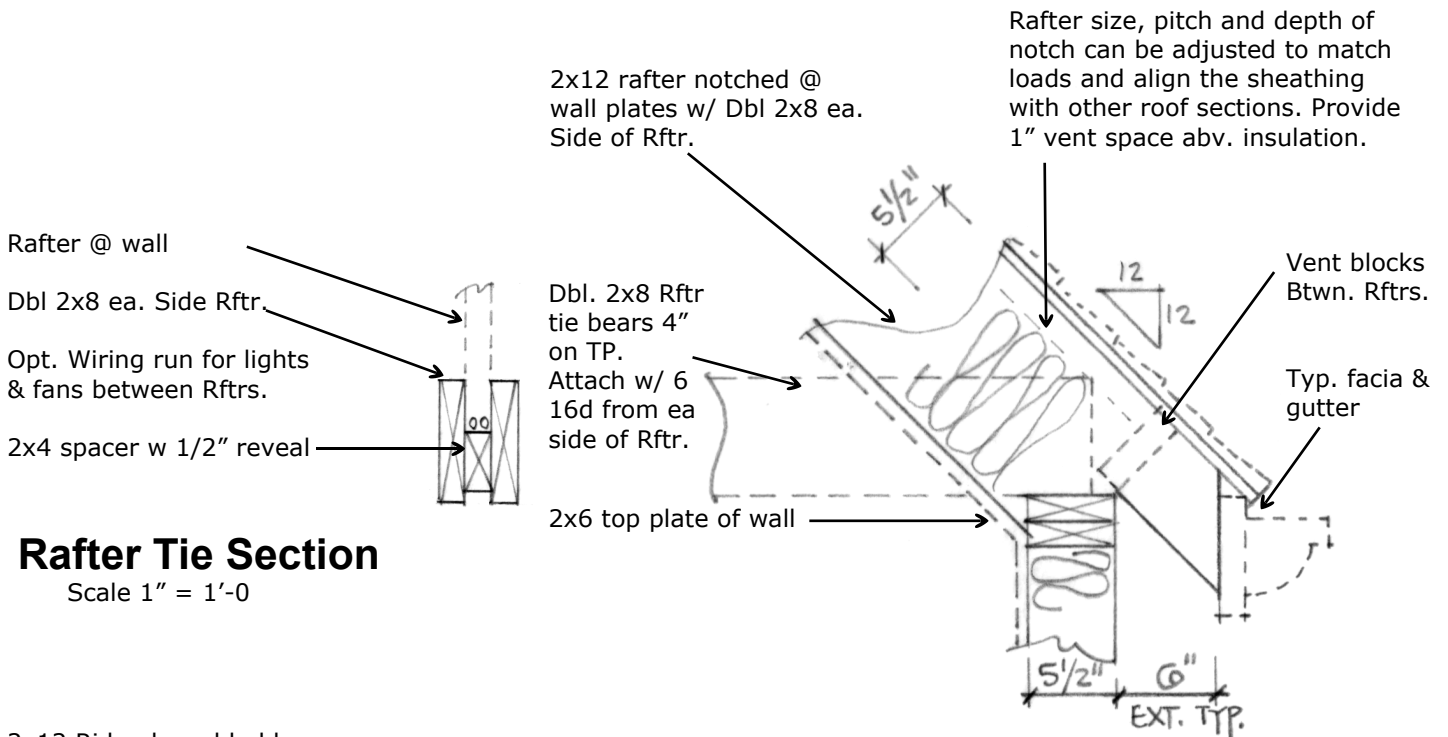

Rafter Tie Section

Scale 1" = 1'-0

2x12 Ridge board held low to provide venting to ridge vent above.

Connection at Wall

Scale 1" = 1'-0

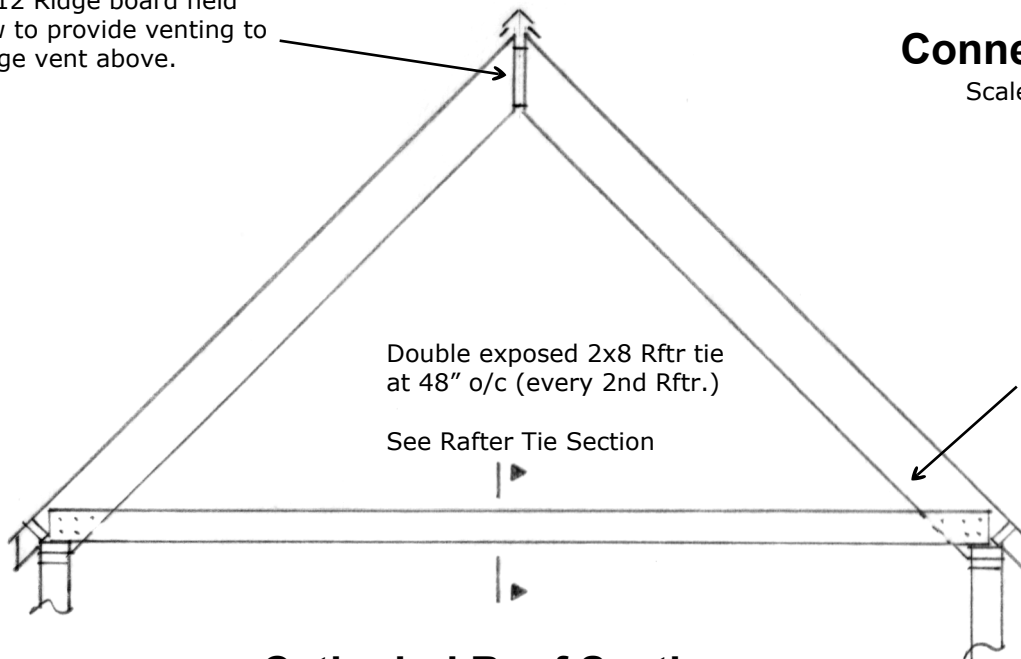

Cathedral Roof Section

Scale 1/4" = 1'-0

Cathedral Ceiling Details

The details presented here can be used in the areas of the 20' wide cottage house where you don't need a loft. This will give you a full cathedral ceiling over the living room (for instance) with heavy timber like beams tying the walls together every 4'.